

LSM-35WD

3.6W INDOOR AUTO WARM-DIM FLEXIBLE LED STRIP

Project _____
Location _____
Quote/ Ref # _____

LSM-35WD is a warm-dim LED strip with smart chip technology. Using a standard wall box dimmer, this LED strip automatically shifts color temperature from 3000K down to 1800K as it is being dimmed down. LSM-35WD provides warm-dim technology at a fraction of the price without the need for any special lighting control system.



SPECIFICATIONS

INPUT VOLTAGE	24V DC
POWER CONSUMPTION	3.6W per Ft.
LUMEN OUTPUT	210 Lumens per Ft.
NO. OF LEDS	64 LEDs per Ft.
BEAM ANGLE	120°
CRI	95+
DIMMING/ CONTROL	MLV, ELV, 0-10 AND TRIAC
MAXIMUM RUN LENGTH	21 Ft.
FIELD CUTTABLE	Every 2.4 in
IP RATING	IP45 dry location (Indoor)
OPERATING TEMPERATURE	-40°F (-40°C) ~ 140°F (60°C)
BINNING	1.5 Step Macadam Elipse
LUMEN MAINTENANCE	50,000 Hrs.
CERTIFICATIONS	UL Listed, TITLE 24 JA8
DIMENSIONS	0.47" x 0.04" (11.9mm x 1.2mm) (WxH)
WARRANTY	5 Years

FEATURES

- 3.6W per Ft
- Auto Warm-Dim Technology
- Field cuttable
- Suitable for accent or ambient lighting
- Ideal for Commercial and Residential Applications
- No Special Controllers Required
- Superior COLOR RENDERING INDEX (CRI)
- Architectural Grade LED Lighting
- UL Listed
- California TITLE 24 JA8 Compliant
- Approved for closet / storage space installation per NEC 410.16(A)(3) and 410.16(C)(5)



MODEL	COLOR TEMP	LENGTH	VOLTAGE	PROFILE
LSM35WD	18K/27K 1800K/2700K	16 16.4 Ft.	24V 24 Volts	<i>See Page 3 for compatible profiles.</i>
	18K/30K 1800K/3000K	100 100 Ft.		
	1XX per Ft.			

*1 = Custom length per FT.
(Cuttable every 2.4")

* Custom color finishes require powder coating. Allow 7 days leads time.

LSM-35WD

3.6W INDOOR AUTO WARM-DIM FLEXIBLE LED STRIP

DIMENSIONS

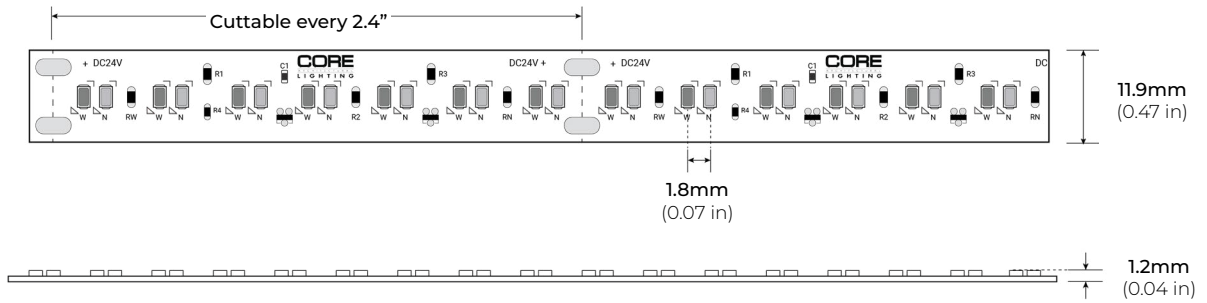

COMPATIBLE CONNECTORS

HP PRO CONNECTORS

QUICK CONNECT SNAP-ON

- LSA-HW8-HP 8" CONNECTOR
- LSA-HW24-HP 24" CONNECTOR
- LSA-HW60-HP 60" CONNECTOR
- LSA-HW120-HP 120" CONNECTOR

- LSA-EX3-HP 3" LINK
- LSA-EX8-HP 8" LINK
- LSA-EX24-HP 24" LINK

- LSA-DC24-HP-X10 24" DC CONNECTOR

- LSA-DC24-HP-X10 24" DC CONNECTOR

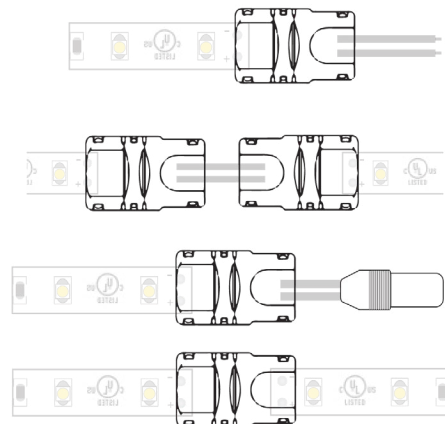

LSM-35WD

3.6W INDOOR AUTO WARM-DIM FLEXIBLE LED STRIP

COMPATIBLE ALUMINUM PROFILES

SURFACE PROFILES

ALU-SF

LENGTHS 39³/₈" | 78⁷/₈" | 84" | 98"
LENS Clear, Frosted
FINISH Black | Silver

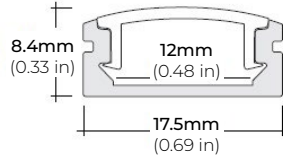

ALU-CN (CORNER)

LENGTHS 39³/₈" | 78⁷/₈" | 84" | 96"
LENS Clear, Frosted
FINISH Black | Silver

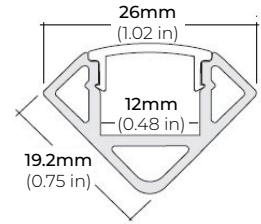

ALU-DS100

LENGTHS 39³/₈" | 78⁷/₈" | 84"
LENS Clear, Frosted
FINISH Silver

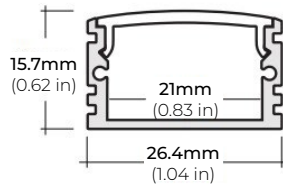

ALP-50C (CORNER)

LENGTHS 49" | 84" | 98.5"
LENS Frosted
FINISH Black | Silver

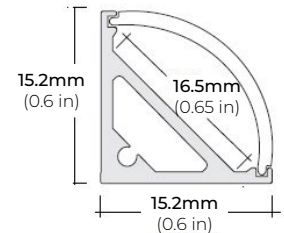

ALP-70

LENGTHS 49.25" | 84" | 98.5"
LENS Frosted
FINISH White | Black | Silver

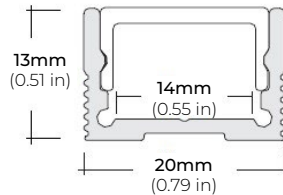

ALP-75C (CORNER)

LENGTHS 48" | 84" | 98.5"
LENS Frosted
FINISH Black | Silver

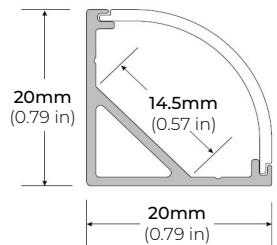

ALP-80

LENGTHS 49.25" | 98.5"
LENS Frosted
FINISH Silver

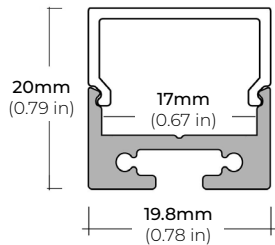

RECESSED PROFILES

ALP-60R

LENGTHS 49.25" | 84" | 98.5"
LENS Frosted
FINISH White | Black | Silver

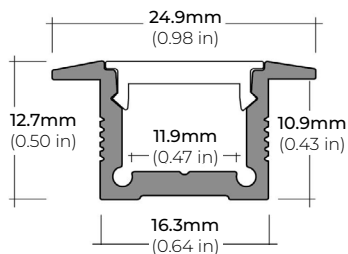

ALP-70R

LENGTHS 48" | 98"
LENS Frosted
FINISH Black | Silver

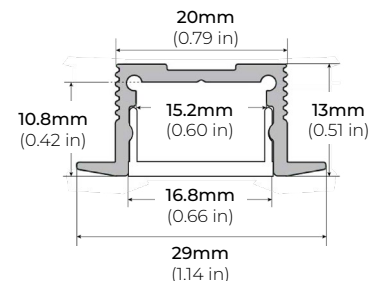

LSM-35WD

3.6W INDOOR AUTO WARM-DIM FLEXIBLE LED STRIP

COMPATIBLE TRANSFORMERS

PSDL SERIES TRIAC DIMMABLE

PSDL-30W-24V	CLASS 2	6.5" X 3.63" X 1.58"
PSDL-60W-24V	CLASS 2	7.4" X 3.63" X 1.58"
PSDL-96W-24V	CLASS 2	8.67" X 3.67 X 1.62"
PSDL-150W-24V		10.25" X 4.06" X 1.82"
PSDL-192W-24V	CLASS 2	11" X 4" X 1.82"
PSDL-200W-24V		10.25" X 4.06" X 1.82"
PSDL-288W-24V	CLASS 2	11.85" X 4.25" X 1.82"
PSDL-300W-24V		10.25" X 4.06" X 1.82"

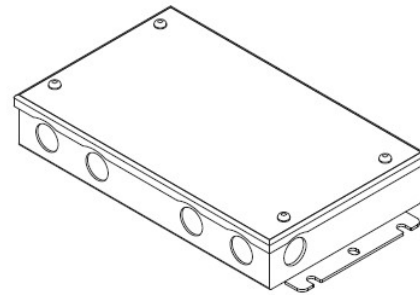

PSDH SERIES HIGH PERFORMANCE MAGNETIC LOW VOLTAGE (MLV)

PSDH-48W-24V	CLASS 2	11.25" X 3.38" X 3.38"
PSDH-96W-24V	CLASS 2	11.25" X 3.38" X 3.37"
PSDH-288W-24V	CLASS 2	14.25" X 8.43" X 4.43"

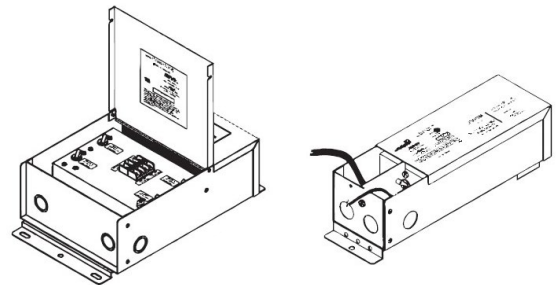

PSRX SERIES 4-IN-1 DIMMING DRIVER W/ JUNCTION BOX

PSRX-30W-24V-UNV	CLASS 2	6.5" X 3.7" X 1.57"
PSRX-60W-24V-UNV	CLASS 2	7.4" X 3.72" X 1.57"
PSRX-96W-24V-UNV	CLASS 2	8.66" X 3.72" X 1.57"
PSRX-150W-24V-UNV		10.24" X 4.13" X 1.77"
PSRX-200W-24V-UNV		10.24" X 4.13" X 1.77"
PSRX-300W-24V-UNV		10.94" X 4.33" X 1.77"

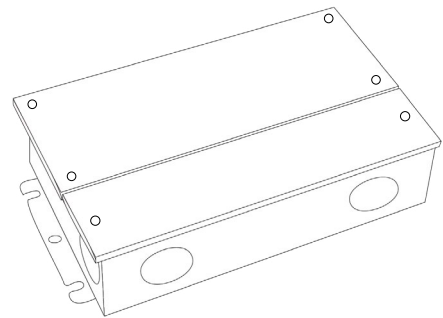

PSVT SERIES 0-10V DIMMING WITH JUNCTION BOX

PSVT-60W-24V-UNV-010	CLASS 2	7.4" X 3.72" X 1.57"
PSVT-96W-24V-UNV-010	CLASS 2	8.66" X 3.72" X 1.57"
PSVT-200W-24V-UNV-010		10.24" X 4.13" X 1.77"
PSVT-288W-24V-UNV-010	CLASS 2	11.85" X 4.25" X 1.81"
PSVT-300W-24V-UNV-010		10.94" X 4.33" X 1.77"

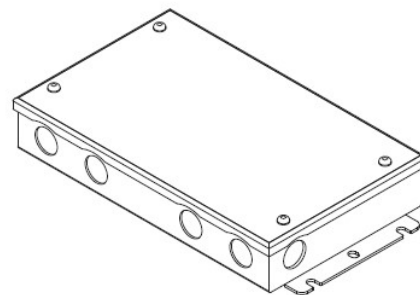

LSM-35WD

3.6W INDOOR AUTO WARM-DIM FLEXIBLE LED STRIP

COMPATIBLE TRANSFORMERS

PSDE SERIES 0-10V DIMMING W/ JUNCTION BOX

PSDE-60W-24V-010-JB	CLASS 2	12.1" X 2.36" X 1.4"
PSDE-96W-24V-010-JB	CLASS 2	12.1" X 2.36" X 1.4"

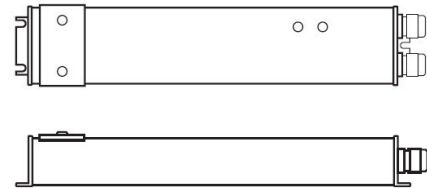

LUTRON 1% 2 OR 3-WIRE DIMMING

LTEA4U1UKL-CV240	CLASS 2	4.89" X 4" X 2.62"
L3DA4U1UKL-CV240	CLASS 2	4.89" X 4" X 2.62"

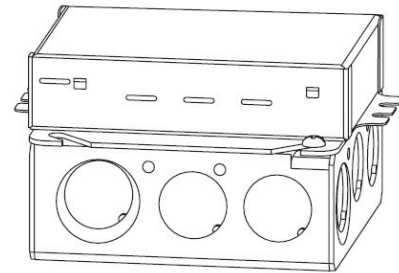

LUTRON 1%

PSDE-96W-24V-ECO	CLASS 2	10.5" X 3.0" X 2.0"
------------------	---------	---------------------

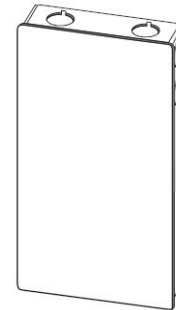

COMPATIBLE NON-DIMMING DRIVERS

PSHK SERIES NON-DIMMING CONSTANT VOLTAGE WITH JUNCTION BOX

PSHK-30W-24V	CLASS 2	6.5" X 3.6" X 1.02"
PSHK-60W-24V	CLASS 2	7.4" X 3.62" X 1.02"
PSHK-96W-24V	CLASS 2	8.66" X 3.66" X 1.61"
PSHK-150W-24V		10.24" X 4.06" X 1.81"
PSHK-200W-24V		10.24" X 4.06" X 1.81"
PSHK-288W-24V	CLASS 2	11.85" X 4.25" X 1.82"
PSHK-300W-24V		10.24" X 4.25" X 1.81"

