

LSM-55WD

5.5W INDOOR AUTO WARM-DIM FLEXIBLE LED STRIP

Project _____
Location _____
Quote/ Ref # _____

LSM-55WD is a new warm-dim LED strip with smart chip technology. Using a standard wall box dimmer, LED light source automatically shifts color temperature from 3000K down to 1800K as it is being dimmed. LSM-55WD provides Warm-Dim technology at a fraction of the price without the need for any special lighting control system.

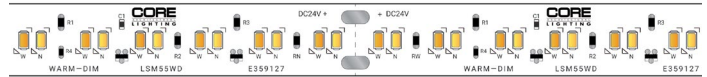

SPECIFICATIONS

INPUT VOLTAGE	24V DC
POWER CONSUMPTION	5.5W per Ft.
NO. OF LEDS	64 LEDs per Ft.
LUMEN OUTPUT	370 Lm/Ft.
CRI	95+
DIMMING/ CONTROL	MLV, ELV, 0-10 and TRIAC
MAXIMUM RUN LENGTH	16 Ft.
FIELD CUTTABLE	Every 2.4 in (61.1mm)
BINNING	1.5 Step Macadam Elipse
OPERATING TEMPERATURE	-40°F (-40°C) ~ 140°F (60°C)
BEAM ANGLE	120°
IP RATING	IP45 dry location (Indoor)
CERTIFICATIONS	UL Listed, TITLE 24 JA8, RoHS
LUMEN MAINTENANCE	50,000 Hrs.

FEATURES

- 5.5W per Ft
- 370 Lm/Ft.
- 95+ CRI
- Auto Warm-Dim Technology
- Field cuttable
- Suitable for accent or ambient lighting
- Multiple CCT options available
- Dimmable with CORE dimmable Drivers
- California TITLE 24 JA8 Compliant
- UL Listed

*Approved for closet / storage space installation per NEC 410.16(A)(3) and 410.16(C)(5)



MODEL	COLOR TEMP	LENGTH	VOLTAGE	PROFILE
LSM-55WD	18/27K 1800K/ 2700K	16 16.4 Ft.	24 24V DC	<i>See Page 3 for compatible profiles.</i>
	18/30K 1800K/ 3000K	100 100 Ft.		
		1XX per Ft.		

*1 = Custom length per FT.
(Cuttable every 2.4")

* Custom color finishes require powder coating. Allow 7 days leads time.

LSM-55WD

5.5W INDOOR AUTO WARM-DIM FLEXIBLE LED STRIP

DIMENSIONS

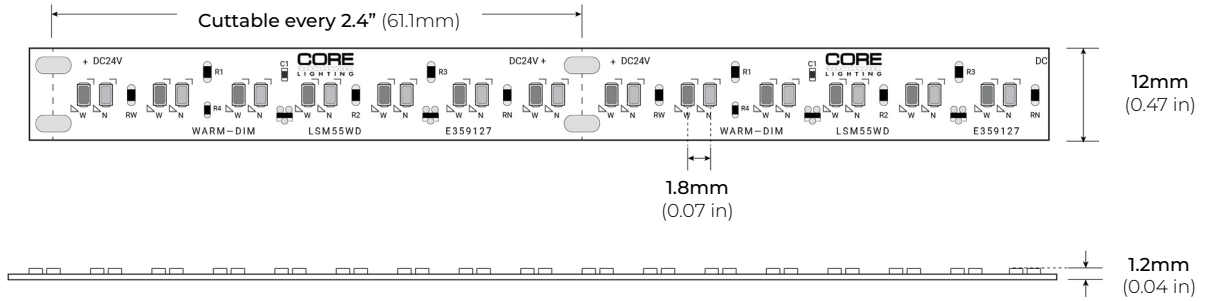

COMPATIBLE CONNECTORS

HP PRO CONNECTORS

QUICK CONNECT SNAP-ON

- LSA-HW8-HPX10 8" HARDWIRE CONNECTOR
- LSA-HW24-HPX10 24" HARDWIRE CONNECTOR
- LSA-HW60-HPX10 60" HARDWIRE CONNECTOR
- LSA-HW120-HPX10 120" HARDWIRE CONNECTOR

- LSA-EX3-HPX10 3" LINK
- LSA-EX8-HPX10 8" LINK
- LSA-EX24-HPX10 24" LINK

- LSA-DC24-HP-X10 24" DC CONNECTOR

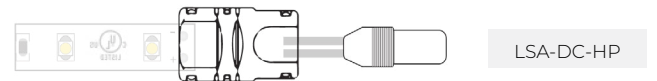
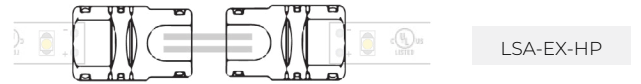
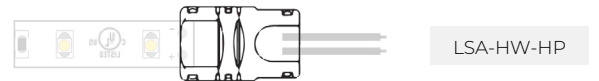

LSM-55WD

5.5W INDOOR AUTO WARM-DIM FLEXIBLE LED STRIP

COMPATIBLE ALUMINUM PROFILES

SURFACE PROFILES

ALU-SF

LENGTHS 39" | 78" | 84" | 98"
LENS Clear, Frosted
FINISH Black | Silver

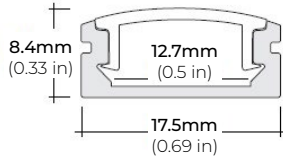

ALU-CN (CORNER)

LENGTHS 39" | 78" | 84" | 96"
LENS Clear, Frosted
FINISH Silver

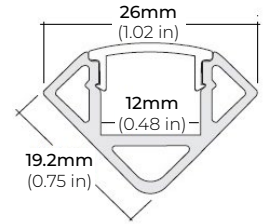

ALU-DS100

LENGTHS 39" | 78" | 84"
LENS Clear, Frosted
FINISH Silver

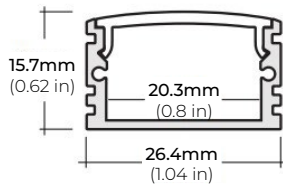

ALP-50C (CORNER)

LENGTHS 48" | 84" | 98"
LENS Frosted
FINISH Black | Silver

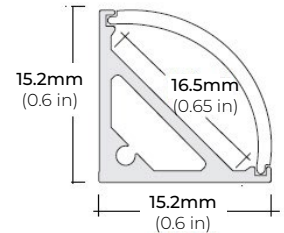

ALP-70

LENGTHS 49" | 84" | 98"
LENS Frosted
FINISH Black | Silver

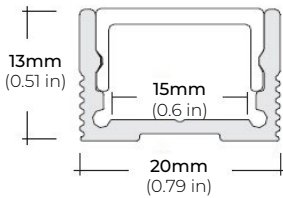

ALP-75C (CORNER)

LENGTHS 49" | 84" | 98"
LENS Frosted
FINISH Black | Silver

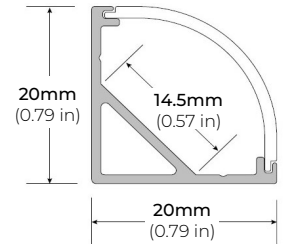

ALP-80

LENGTHS 49" | 98"
LENS Frosted
FINISH Silver

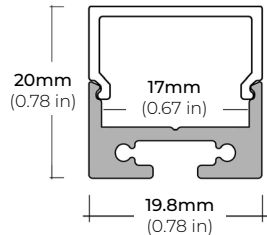

ALP-90

LENGTHS 48" | 96"
LENS Frosted
FINISH Black | Silver

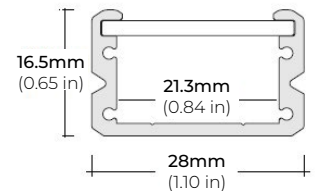

* For more compatible profiles, visit corelightingusa.com

RECESSED PROFILES

ALP-70R

LENGTHS 48" | 98"
LENS Frosted
FINISH Black | Silver

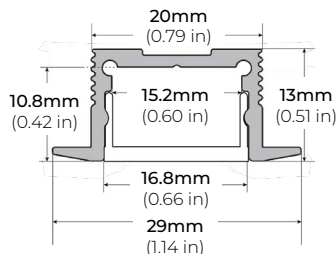

ALP-102R

LENGTHS 49" | 98"
LENS Frosted, Black, Asymmetric, Double Asymmetric
FINISH Silver

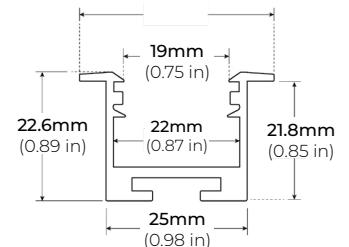

* For more compatible profiles, visit corelightingusa.com

LSM-55WD

5.5W INDOOR AUTO WARM-DIM FLEXIBLE LED STRIP

COMPATIBLE TRANSFORMERS

PSDL SERIES TRIAC DIMMABLE

PSDL-30W-24V	CLASS 2	6.5" X 3.63" X 1.03"
PSDL-60W-24V	CLASS 2	7.4" X 3.63" X 1.03"
PSDL-96W-24V	CLASS 2	8.67" X 3.67 X 1.62"
PSDL-150W-24V		8.67" X 3.67" X 1.62"
PSDL-192W-24V	CLASS 2	10.25" X 4.06" X 1.82"
PSDL-200W-24V		10.25" X 4.06" X 1.82"
PSDL-288W-24V	CLASS 2	10.25" X 4.06" X 1.82"
PSDL-300W-24V		10.25" X 4.06" X 1.82"

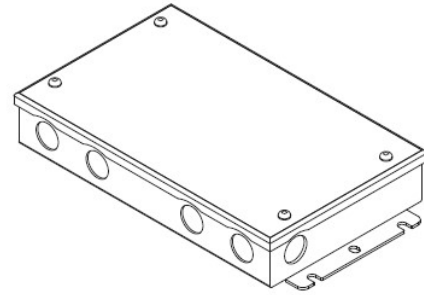

PSDH SERIES HIGH PERFORMANCE MAGNETIC LOW VOLTAGE (MLV)

PSDH-48W-24V	CLASS 2	11.25" X 3.37" X 3.25"
PSDH-96W-24V	CLASS 2	11.25" X 3.37" X 3.25"
PSDH-288W-24V	CLASS 2	14.25" X 8.43" X 4.43"

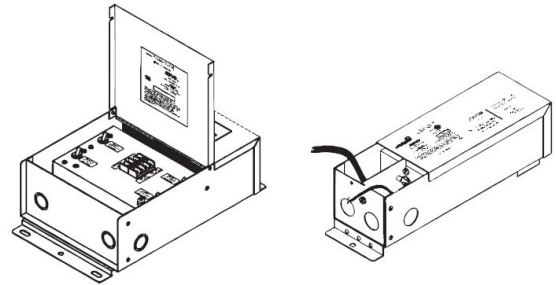

PSRX SERIES 4-IN-1 DIMMING DRIVER

PSRX-30W-24V	CLASS 2	6.5" X 3.72" X 1.57"
PSRX-60W-24V	CLASS 2	7.4" X 3.72" X 1.57"
PSRX-96W-24V	CLASS 2	8.66" X 3.72" X 1.57"
PSRX-150W-24V		10.24" X 4.13" X 1.77"
PSRX-192W-24V	CLASS 2	11" X 4" X 1.82"
PSRX-200W-24V		10.24" X 4.13" X 1.77"
PSRX-288W-24V	CLASS 2	11.85" X 4.25" X 1.82"
PSRX-300W-24V		10.94" X 4.33" X 1.77"

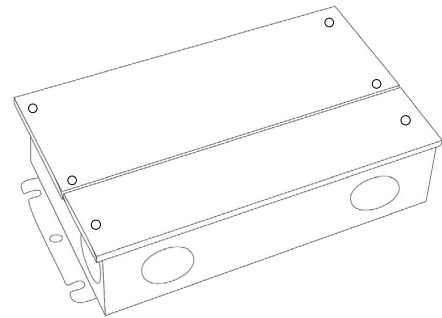

PSVT SERIES 0-10V DIMMING DRIVER

PSVT-60W-24V	CLASS 2	7.4" X 3.72" X 1.57"
PSVT-96W-24V	CLASS 2	8.66" X 3.72" X 1.57"
PSVT-200W-24V		10.24" X 4.13" X 1.77"
PSVT-288W-24V	CLASS 2	11.85" X 4.25" X 1.81"
PSVT-300W-24V		10.94" X 4.33" X 1.77"

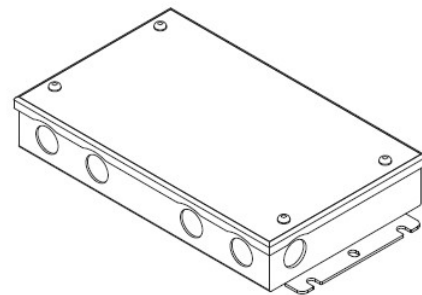

LSM-55WD

5.5W INDOOR AUTO WARM-DIM FLEXIBLE LED STRIP

COMPATIBLE TRANSFORMERS

PSDE SERIES
0-10V DIMMING W/ JUNCTION BOX

PSDE-60W-24V-010-JB	CLASS 2	12.1" X 2.36" X 1.4"
PSDE-96W-24V-010-JB	CLASS 2	12.1" X 2.36" X 1.4"

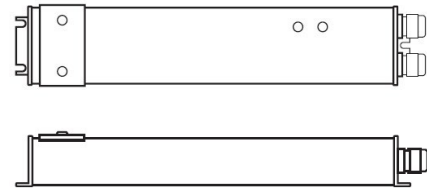

LUTRON 1%
3-WIRE DIMMING

L3DA4U1UKL-CV240	CLASS 2	4.89" X 4" X 2.62"
------------------	---------	--------------------

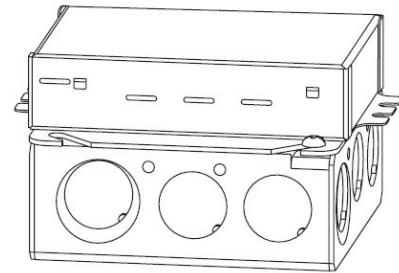

LUTRON 1%

PSDE-96W-24V-ECO	CLASS 2	10.5" X 3.0" X 2.0"
------------------	---------	---------------------

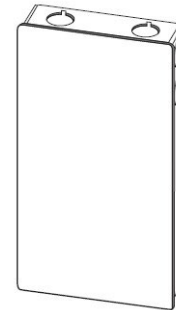

COMPATIBLE NON-DIMMING DRIVERS

PSHK SERIES
NON-DIMMING CONSTANT VOLTAGE WITH JUNCTION BOX

PSHK-30W-24V	CLASS 2	6.5" X 3.6" X 1.02"
PSHK-60W-24V	CLASS 2	7.4" X 3.62" X 1.02"
PSHK-96W-24V	CLASS 2	8.66" X 3.66" X 1.61"
PSHK-150W-24V		10.24" X 4.06" X 1.81"
PSHK-200W-24V		10.24" X 4.06" X 1.81"
PSHK-288W-24V	CLASS 2	11.85" X 4.25" X 1.82"
PSHK-300W-24V		10.24" X 4.25" X 1.81"

